



PE

STRUCTURE



PE

FLOAT

RBM12

Buoys for shallow waters

This buoy has been especially designed to be used during work periods, danger marking, emergency buoys or in shallow waters.

Rotomoulded polyethylene

Float made from high-quality rotomoulded virgin polyethylene, divided into two sections. Polyethylene includes the necessary pigment that provides the colour. UV filters guarantee a stable colour protection during its whole service life. It incorporates reinforcements from the waterline to the mooring eye. To ensure its buoyancy, the float is filled with closed-cell expanded polyurethane foam.

Long service life

Metallic buoy parts (superstructure and tail) are made from hot-dip galvanized steel, providing a long service life under harsh marine conditions. They can be customized under client's request, as well as to be made from stainless steel or marine aluminium.



Region A



Region A

FEATURES

- Float made from high-quality rotomoulded virgin polyethylene of 10 mm thickness. Other thicknesses available on request.
- Float filled with closed-cell expanded polyurethane foam inside.
- Metallic parts from hot-dip galvanized steel.
- Colour impregnated in the polyethylene.
- Chromaticity according to IALA Recommendations.
- UV protection.
- Compatible with a large variety of self-contained lanterns.
- Top mark to increase buoy conspicuity at daytime.
- Stainless steel hardware.
- Minimum maintenance.
- Designed according to IALA Recommendations.

RBM12

	(D) Float diameter	(A) Focal Height	(FH) Float Height	(C) Draft	(H) Total height	Float Volume	Total weight	Max. chain
RBM12	1.25 m	1.5 m	0.6 m	1.35 m	3.27 m	0.5 m ³	212 kg	200 kg

* Other volumes and heights available under request.

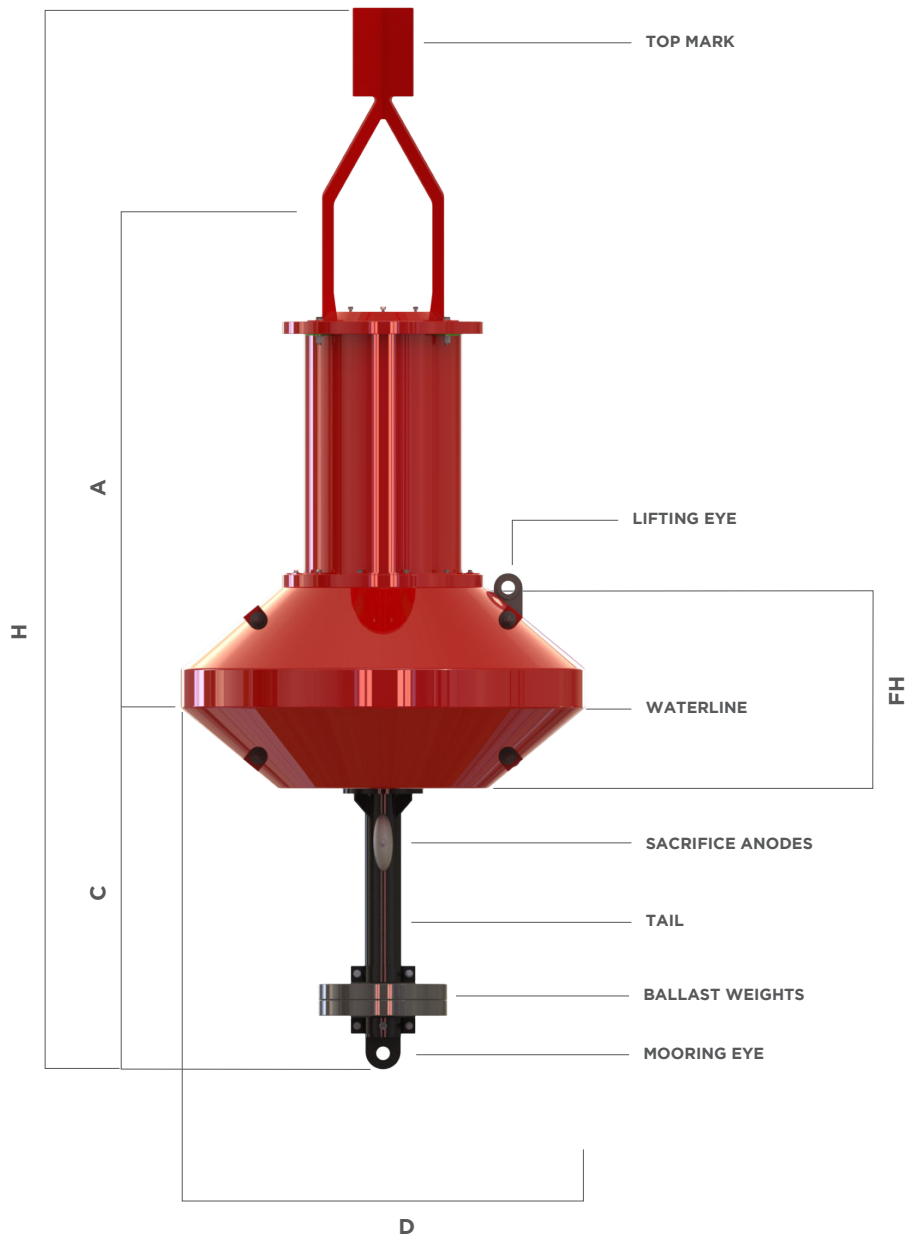

Region A

RBM12

■ Versions

RBM12

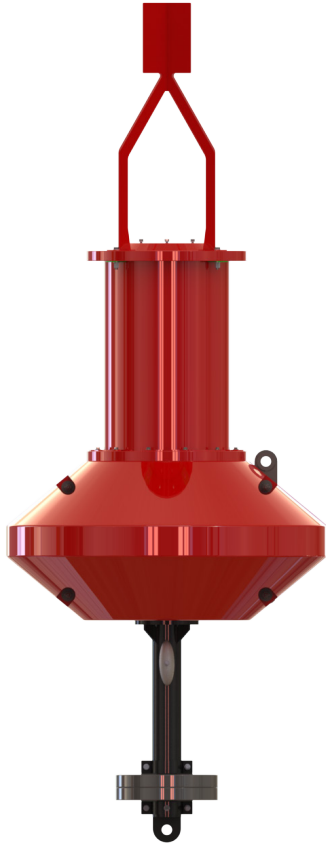

Region A

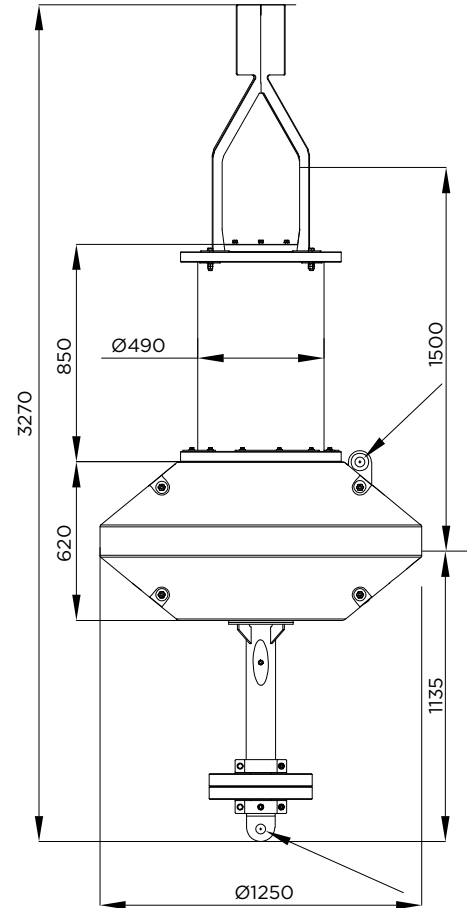

RBM12

Superstructure

Material:	12 mm thickness rotomoulded virgin polyethylene.
Coating:	UV and marine environment resistant polyurethane coating.
Top mark:	Marine aluminium.
Lifting eyes:	1 no.
Hardware:	Stainless-steel.

Float

Diameter:	1,25 metros.
Material:	10 mm thickness rotomoulded virgin polyethylene.
Filling:	Closed-cell expanded polyurethane foam.

Tail

Material:	Hot-dip galvanized steel.
Ballast weights:	Treated steel, detachable.
Mooring eyes:	1 nos.
Protection:	Sacrifice anodes.

Options

Cast-iron ballast weights.
Polystyrene filling available under request.
Short tail available (PBM12).
Passive radar reflector of 8 m² RCS.
Other thicknesses available on request.



Specifications subject to change without previous notice.



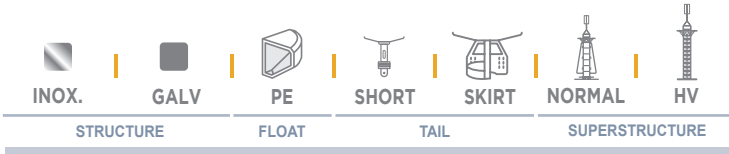

RBM15

Rotomoulded polyethylene

RBM15 polyethylene buoys are designed for both sheltered and open-sea waters, thanks to the large capacity of its float of 1.5 meters in diameter, in high-quality rotomoulded virgin polyethylene.

UV protection

Polyethylene includes the necessary pigment that provides the colour. UV filters guarantee a stable colour protection during its whole service life. To ensure its buoyancy, the float is filled with closed-cell expanded polyurethane foam.

Long service life

Metallic buoy parts (superstructure and tail) made from hot-dip galvanized steel, and designed to provide a long service life under the harshest marine conditions. There are standard models with a skirt, short tail or high visibility frame, to meet the most specific markup needs. They can be customized under client's request.

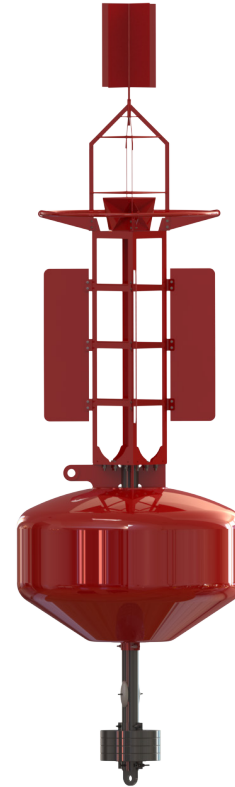

Region A



Region A

FEATURES

- Float made from high-quality rotomoulded virgin polyethylene of 12 mm thickness. Other thicknesses available on request.
- Float filled with closed-cell expanded polyurethane foam inside.
- Metallic parts from hot-dip galvanized steel.
- Colour impregnated in the polyethylene.
- Chromaticity according to IALA Recommendations.
- UV protection.
- Compatible with a large variety of self-contained lanterns.
- Top mark to increase buoy conspicuity at daytime.
- Stainless steel hardware.
- Minimum maintenance.
- Designed according to IALA Recommendations.

RBM15

	(D) Float diameter	(A) Focal Height	(FH) Float Height	(C) Draft	(H) Total height	Float Volume	Total weight	Max. chain
RBM15	1.5 m	2.7 m	1.0 m	1.34 m	5.0 m	1.3 m ³	470 kg	700 kg
RBM15F	1.5 m	2.8 m	1.0 m	1.10 m	4.70 m	1.3 m ³	518 kg	600 kg
RBM15HV	1.5 m	2.8 m	1.0 m	1.30 m	5.10 m	1.3 m ³	409 kg	700 kg

* Other volumes and heights available under request.

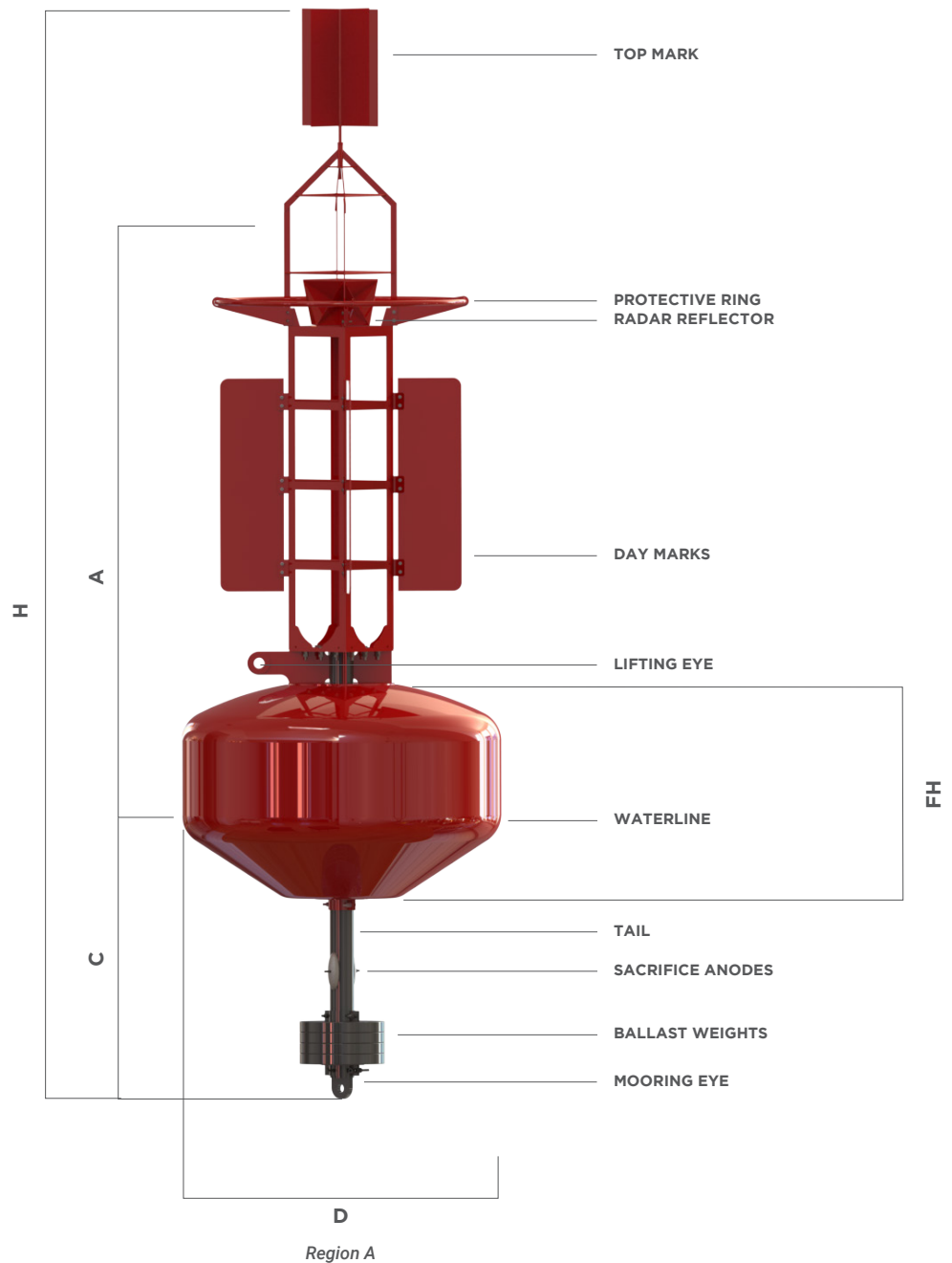

RBM15

■ Versions

RBM15

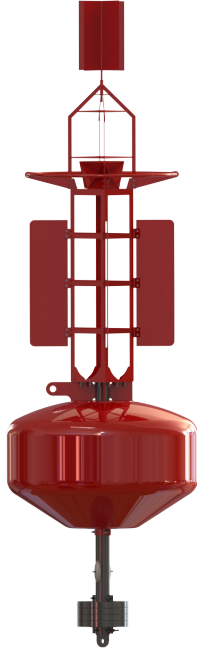

RBM15HV



RBM15F

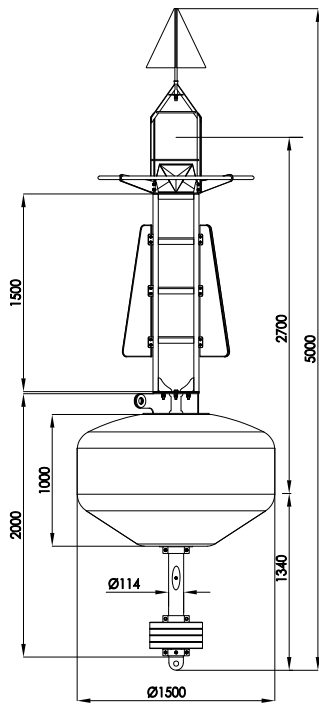

Region A

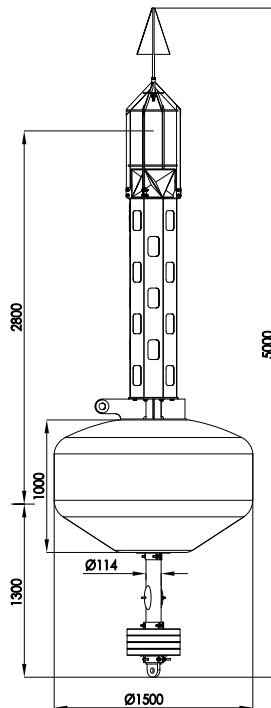

Region A

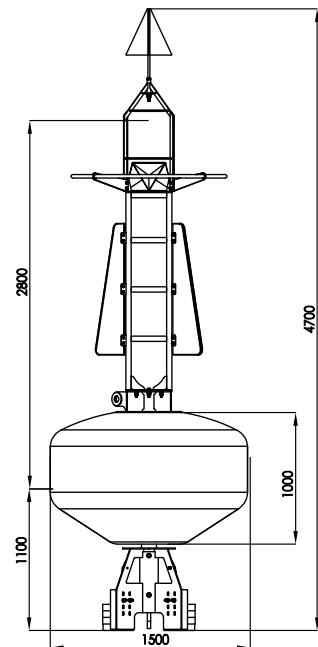

Region A

RBM15

Superstructure

Material:	Hot-dip galvanized steel.
Coating:	UV- and corrosion-resistant polyurethane paint.
Day marks:	GRP.
Top mark:	GRP, according to IALA Recommendation..
Radar reflector:	10 m ² (X band).
Lifting eyes:	1 no.
Hardware:	Stainless-steel.

Float

Diameter:	1.5 meters.
Material:	12 mm rotomoulded virgin polyethylene.
Filling:	Closed-cell expanded polyurethane foam.

Tail

Material:	Hot-dip galvanized steel.
Ballast weights:	Treated steel, detachable.
Mooring eye:	1 no.
Protection:	Sacrifice anodes.

Options

Superstructure made from stainless-steel (RBM15-X).
Top marks available in stainless-steel.
High-visibility day marks.
Cast-iron ballast weights.
Polystyrene filling available under request.
Other thicknesses available on request.



Specifications subject to change without previous notice.



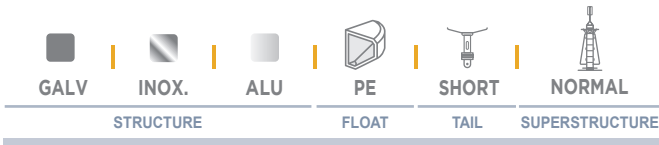

RBM20

Rotomoulded polyethylene

RBM20 polyethylene buoys are designed for both sheltered and open-sea waters, thanks to the large capacity of its float of 2.0 meters in diameter, in high-quality rotomoulded virgin polyethylene.

UV protection

Polyethylene includes the necessary pigment that provides the colour. UV filters guarantee a stable colour protection during its whole service life. To ensure its buoyancy, the float is filled with closed-cell expanded polyurethane foam.

Long service life

Metallic buoy parts (superstructure and tail) made from hot-dip galvanized steel, and designed to provide a long service life under the harshest marine conditions. There are standard models with a short tail or high visibility frame, to meet the most specific markup needs. They can be customized under client's request.



Region A



Region A

FEATURES

- Float made from high-quality rotomoulded virgin polyethylene, 12 mm thickness. Other thicknesses available on request.
- Float filled with closed-cell expanded polyurethane foam inside.
- Metallic parts from hot-dip galvanized steel.
- Impregnated color in polyethylene.
- Chromaticity according to IALA Recommendations.
- Protection against ultraviolet rays.
- Compatible with a large variety of self-contained and marine LED lanterns.
- Top mark to increase the visibility of the buoy during the day.
- Passive radar reflector of 10 m² RCS.
- Stainless steel screws.
- Minimal maintenance.
- Designed according to IALA Recommendations.

RBM20

	(D) Float diameter	(A) Focal Height	(FH) Float Height	(C) Draft	(H) Total height	Float Volume	Total weight	Max. chain
RBM20	2.0 m	4.0 m	1.6 m	1.96 m	7.4 m	4.0 m ³	1,055 kg	1,900 kg

* Other volumes and heights available under request.

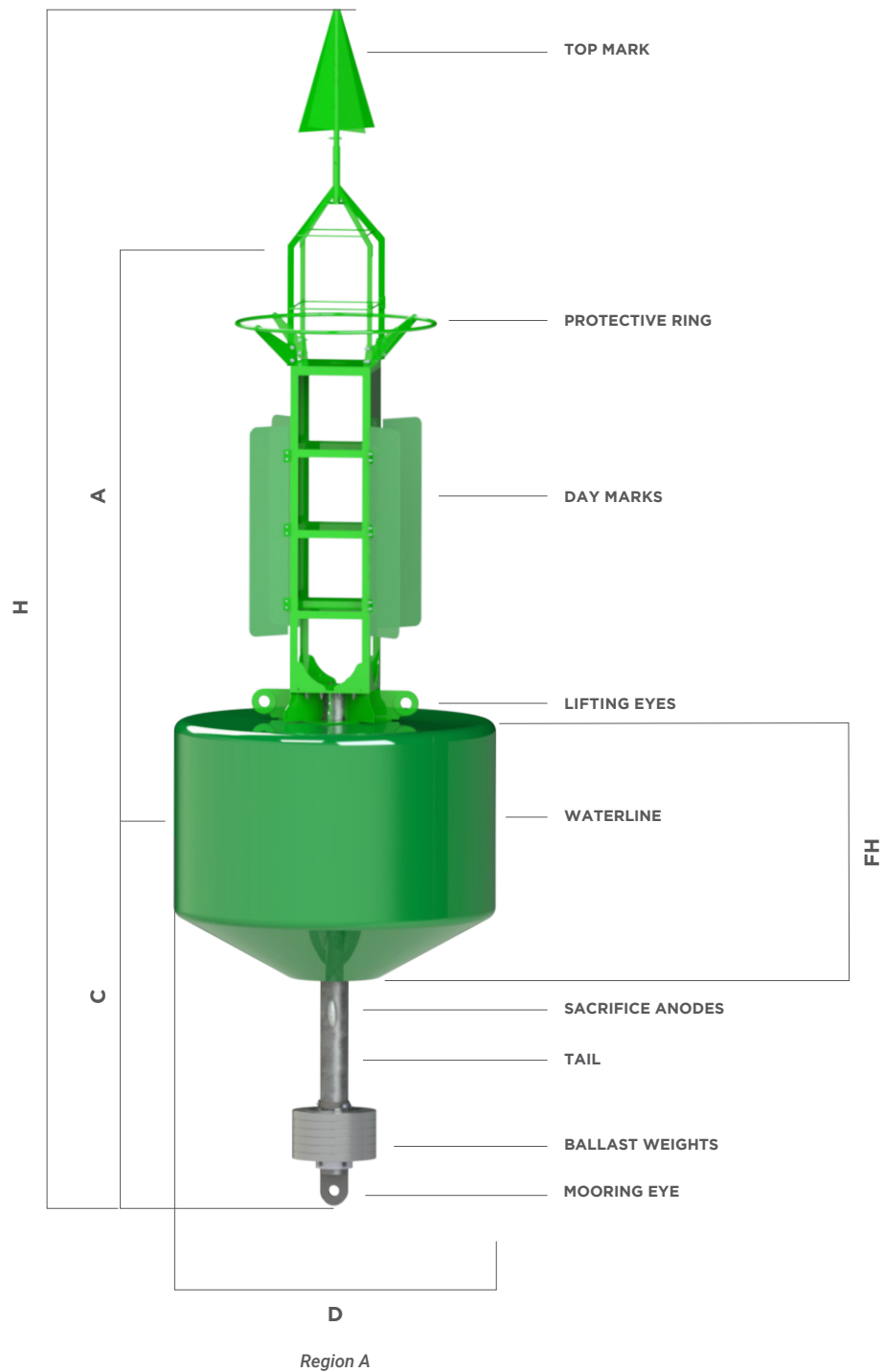

RBM20

■ Versions

RBM20



Region A

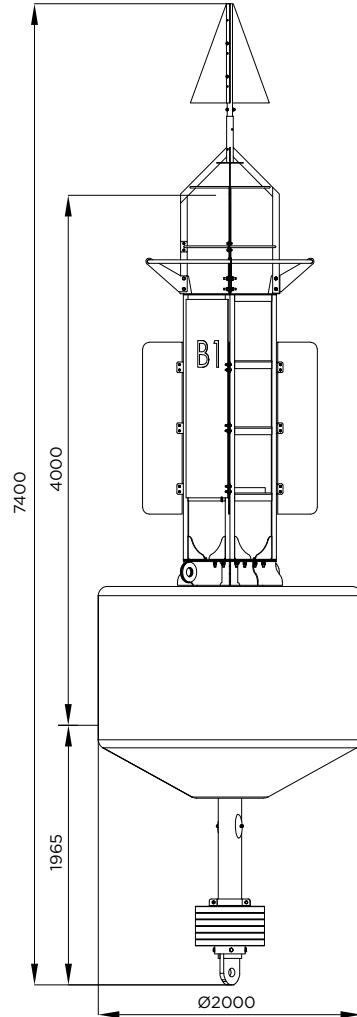

RBM20

Superstructure

Material:	Hot-dip galvanized steel.
Coating:	UV- and corrosion-resistant polyurethane paint.
Day marks:	GRP.
Top mark:	GRP, according to IALA Recommendation.
Radar Reflector:	10 m ² (X band).
Lifting eyes:	2 nos.
Hardware:	Stainless-steel.

Float

Diameter:	2.0 meters.
Material:	12 mm thickness rotomoulded virgin polyethylene.
Filling:	Closed-cell expanded polyurethane foam.

Tail

Material:	Hot-dip galvanized steel.
Ballast weights:	Treated steel, detachable.
Mooring eye:	1 no.
Protection:	Sacrifice anodes.

Options

- Superstructure made from stainless-steel or marine aluminium.
- Top marks available in stainless-steel.
- High-visibility day marks.
- Cast-iron ballast weights.
- Polystyrene filling available under request.
- Short tail available.
- Other thicknesses available on request.



Specifications subject to change without previous notice.



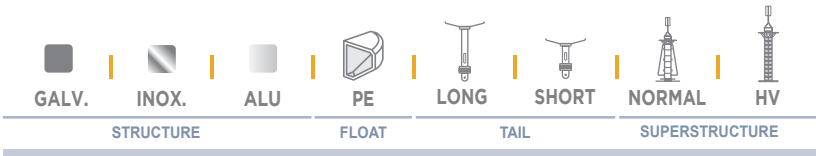

RBM25

Rotomoulded polyethylene

RBM25 polyethylene buoys are designed for both sheltered and open-sea waters, thanks to the large capacity of its float of 2.5 meters in diameter, in high-quality rotomoulded virgin polyethylene.

UV protection

Polyethylene includes the necessary pigment that provides the colour. UV filters guarantee a stable colour protection during its whole service life. To ensure its buoyancy, the float is filled with closed-cell expanded polystyrene foam.

Long service life

The floats are made up of several sections. Metallic buoy parts (superstructure and tail) made from hot-dip galvanized steel, and designed to provide a long service life under the harshest marine conditions. There are standard models with a short tail or high visibility frame, to meet the most specific markup needs. They can be customized under client's request.



Region A

FEATURES

- Float made from high-quality rotomoulded virgin polyethylene, 12 mm thickness. Other thicknesses available on request.
- Float filled with closed-cell expanded polystyrene foam inside.
- Metallic parts from hot-dip galvanized steel
- Impregnated color in polyethylene.
- Chromaticity according to IALA Recommendations.
- Protection against ultraviolet rays.
- Compatible with a large variety of self-contained and marine LED lanterns.
- Top mark to increase the visibility of the buoy during the day.
- Passive radar reflector of 10 m² RCS.
- Stainless steel screws.
- Minimal maintenance.
- Designed according to IALA Recommendations.



Region B

RBM25

	(D) Float diameter	(A) Focal Height	(FH) Float Height	(C) Draft	(H) Total height	Float Volume	Total weight	Max. chain
RBM25	2.5 m	4.7 m	1.9 m	4.18 m	10.5 m	6.0 m ³	1,892 kg	2,400 kg
RBM25HV	2.5 m	4.4 m	1.9 m	4.20 m	9.75 m	6.0 m ³	1,947 kg	2,300 kg

* Other volumes and heights available under request.

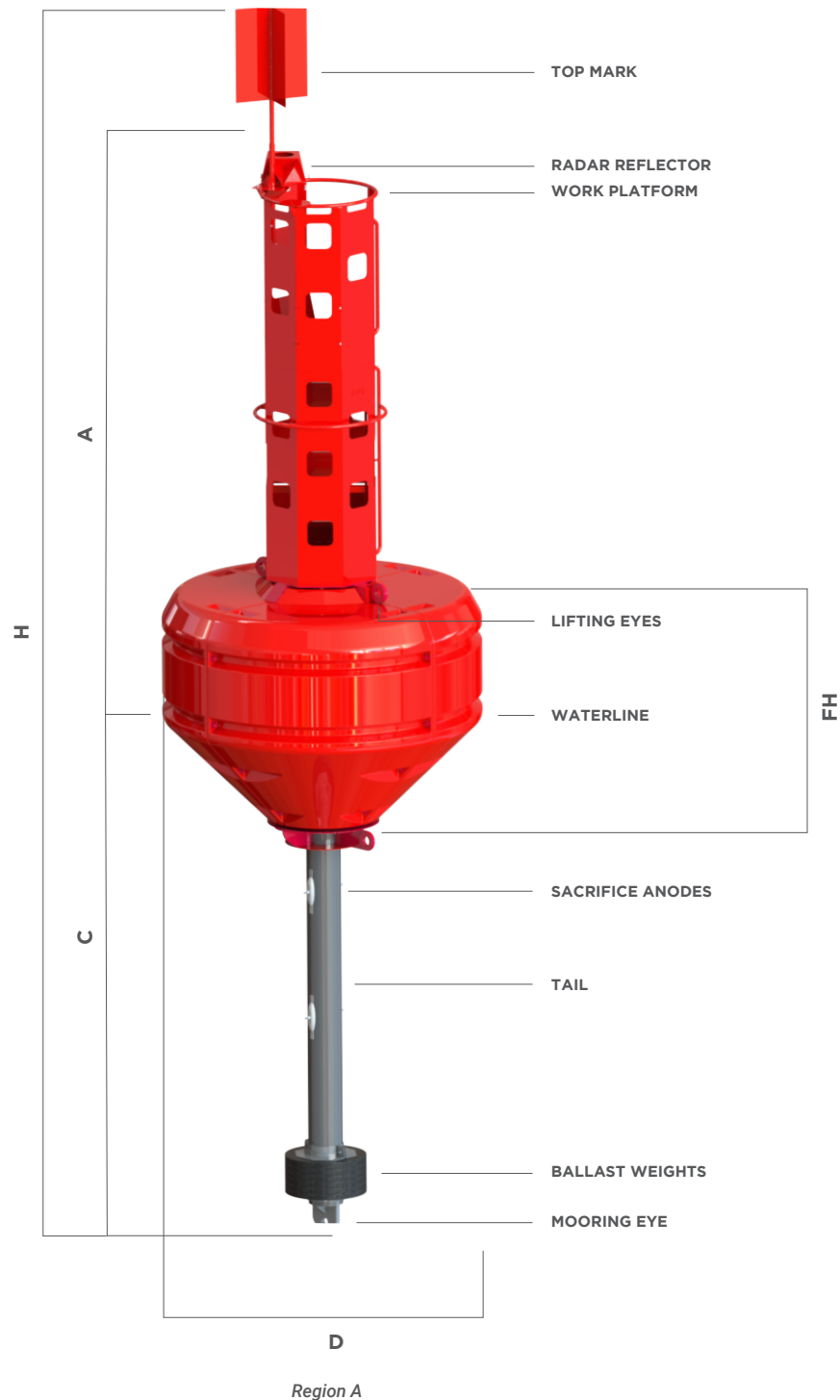

RBM25

■ Versions

RBM25



RBM25HV

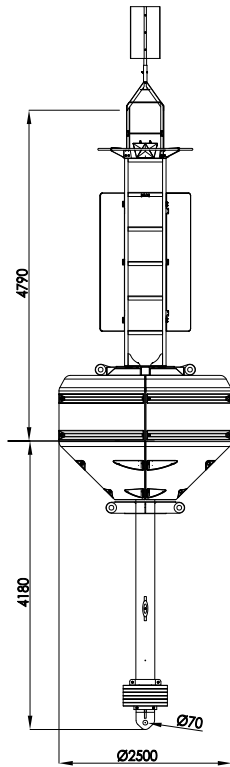

Región A

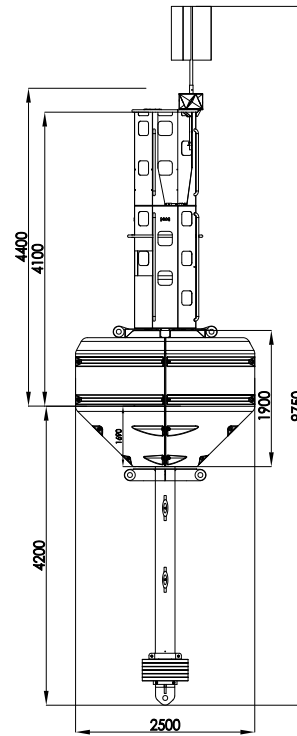

Región A

RBM25

Superstructure

Material:	Hot-dip galvanized steel.
Coating:	UV- and corrosion-resistant polyurethane paint.
Day marks:	GRP.
Top mark:	GRP, according to IALA Recommendation.
Radar Reflector:	10 m ² (X band).
Lifting eyes:	2 nos.
Hardware:	Stainless-steel.

Float

Diameter:	2.5 meters.
Material:	12 mm thickness rotomoulded virgin polyethylene.
Filling:	Closed-cell polystyrene (15 kg/m ³).

Tail

Material:	Hot-dip galvanized steel.
Ballast weights:	Treated steel, detachable.
Mooring eye:	3 nos.
Protection:	Sacrifice anodes.

Options

- Superstructure made from stainless-steel or marine aluminium.
- Top mark available in stainless-steel.
- High-visibility day marks.
- Cast-iron ballast weights.
- Polystyrene filling available under request.
- Short tail available.
- Other thicknesses available on request.



Specifications subject to change without previous notice.



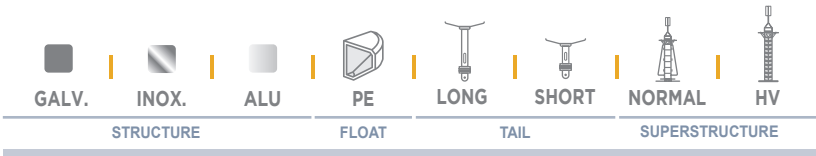

RBM26

Rotomoulded polyethylene

RBM26 polyethylene buoys are designed for both sheltered and open-sea waters, thanks to the large capacity of its float of 2.5 meters in diameter, in high-quality rotomoulded virgin polyethylene.

UV protection

Polyethylene includes the necessary pigment that provides the colour. UV filters guarantee a stable colour protection during its whole service life. To ensure its buoyancy, the float is filled with closed-cell expanded polystyrene foam.

Long service life

The floats are made up of several sections. Metallic buoy parts (superstructure and tail) made from hot-dip galvanized steel, and designed to provide a long service life under the harshest marine conditions. There are standard models with a short tail or high visibility frame, to meet the most specific markup needs. They can be customized under client's request.

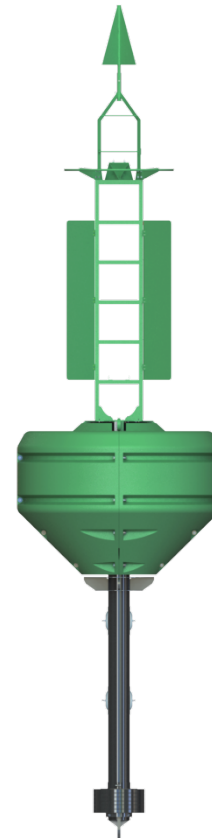

Region A



Region A

FEATURES

- Float made from high-quality rotomoulded virgin polyethylene, 12 mm thickness. Other thicknesses available on request.
- Float filled with closed-cell expanded polystyrene foam inside.
- Metallic parts from hot-dip galvanized steel
- Impregnated color in polyethylene.
- Chromaticity according to IALA Recommendations.
- Protection against ultraviolet rays.
- Compatible with a large variety of self-contained and marine LED lanterns.
- Top mark to increase the visibility of the buoy during the day.
- Passive radar reflector of 10 m² RCS.
- Stainless steel screws.
- Minimal maintenance.
- Designed according to IALA Recommendations.

RBM26

	(D) Float diameter	(A) Focal Height	(FH) Float Height	(C) Draft	(H) Total height	Float Volume	Total weight	Max. chain
RBM26	2.5 m	4.8 m	1.9 m	4.17 m	10.5 m	6.3 m ³	1,917 kg	2,500 kg
RBM26HV	2.5 m	4.5 m	1.9 m	4.16 m	9.75 m	6.3 m ³	1,973 kg	2,600 kg

* Other volumes and heights available under request.

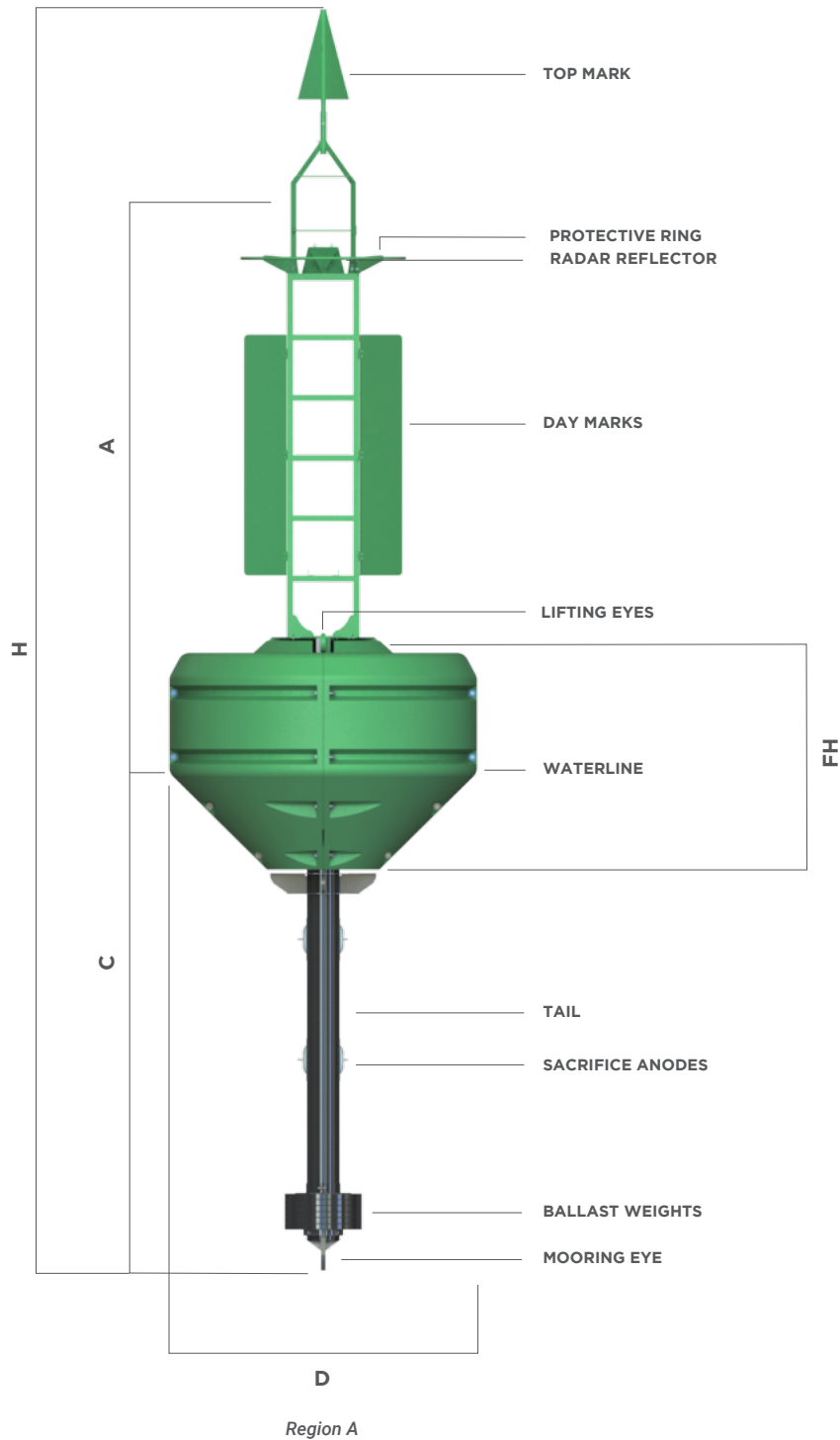

RBM26

■ Versions

RBM26

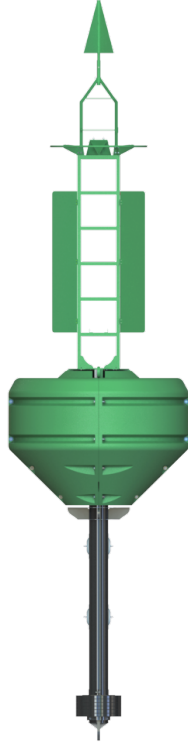

RBM26HV

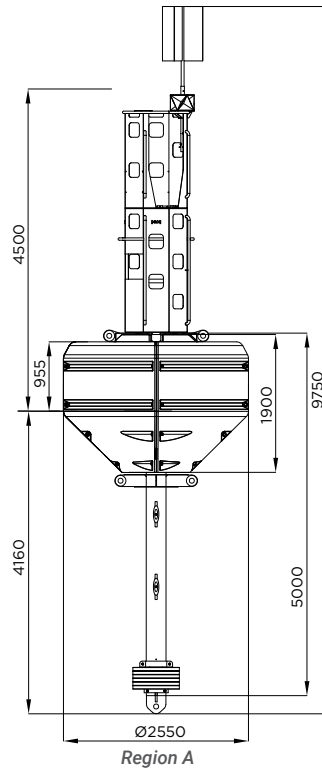
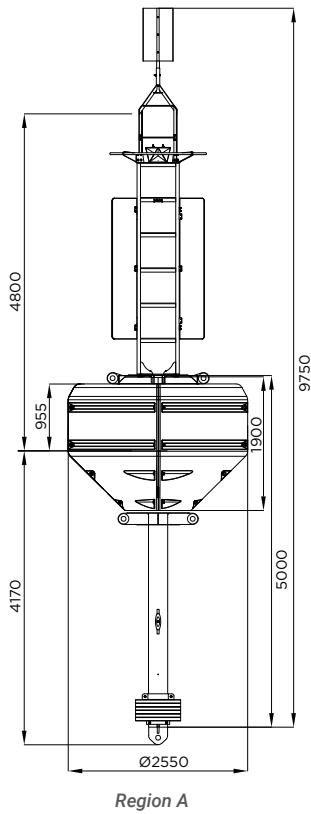

RBM26

Superstructure

Material:	Hot-dip galvanized steel.
Coating:	UV- and corrosion-resistant polyurethane paint.
Day marks:	GRP.
Top mark:	GRP, according to IALA Recommendation.
Radar Reflector:	10 m ² (X band).
Lifting eyes:	2 nos.
Hardware:	Stainless-steel.

Float

Diameter:	2.5 meters.
Material:	12 mm thickness rotomoulded virgin polyethylene.
Filling:	Closed-cell polystyrene (15 kg/m ³).

Tail

Material:	Hot-dip galvanized steel.
Ballast weights:	Treated steel, detachable.
Mooring eye:	1 no.
Protection:	Sacrifice anodes.

Options

- Superstructure made from stainless-steel or marine aluminium.
- Top mark available in stainless-steel.
- High-visibility day marks.
- Cast-iron ballast weights.
- Polystyrene filling available under request.
- Short tail available.
- Other thicknesses available on request.



Specifications subject to change without previous notice.



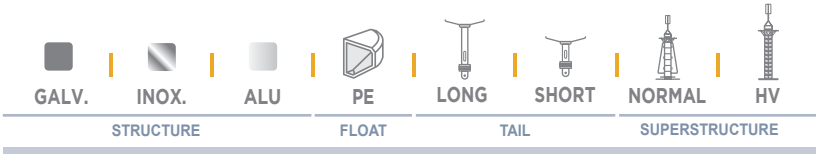

RBM30

Rotomoulded polyethylene

RBM30 polyethylene buoys are designed for both sheltered and open-sea waters, thanks to the large capacity of its float of 3.0 meters in diameter, in high-quality rotomoulded virgin polyethylene.

UV protection

Polyethylene includes the necessary pigment that provides the colour. UV filters guarantee a stable colour protection during its whole service life. To ensure its buoyancy, the float is filled with closed-cell expanded polystyrene foam.

Long service life

The floats are made up of several sections. Metallic buoy parts (superstructure and tail) made from hot-dip galvanized steel, and designed to provide a long service life under the harshest marine conditions. There are standard models with short tail or high visibility frame, to meet the most specific markup needs. They can be customized under client's request.



Region A



FEATURES

- Float made from high-quality rotomoulded virgin polyethylene, 12 mm thickness. Other thicknesses available on request.
- Float filled with closed-cell expanded polystyrene foam inside.
- Metallic parts from hot-dip galvanized steel
- Impregnated color in polyethylene.
- Chromaticity according to IALA Recommendations.
- Protection against ultraviolet rays.
- Compatible with a large variety of self-contained and marine LED lanterns.
- Top mark to increase the visibility of the buoy during the day.
- Passive radar reflector of 10 m² RCS.
- Stainless steel screws.
- Minimal maintenance.
- Designed according to IALA Recommendations.

RBM30

	(D) Float diameter	(A) Focal Height	(FH) Float Height	(C) Draft	(H) Total height	Float Volume	Total weight	Max. chain
RBM30	3.0 m	6.7 m	1.9 m	5.13 m	13.5 m	6.3 m ³	2,588 kg	3,400 kg
RBM30HV	3.0 m	6.4 m	1.9 m	5.12 m	12.5 m	6.3 m ³	2,522 kg	3,300 kg

* Other volumes and heights available under request.

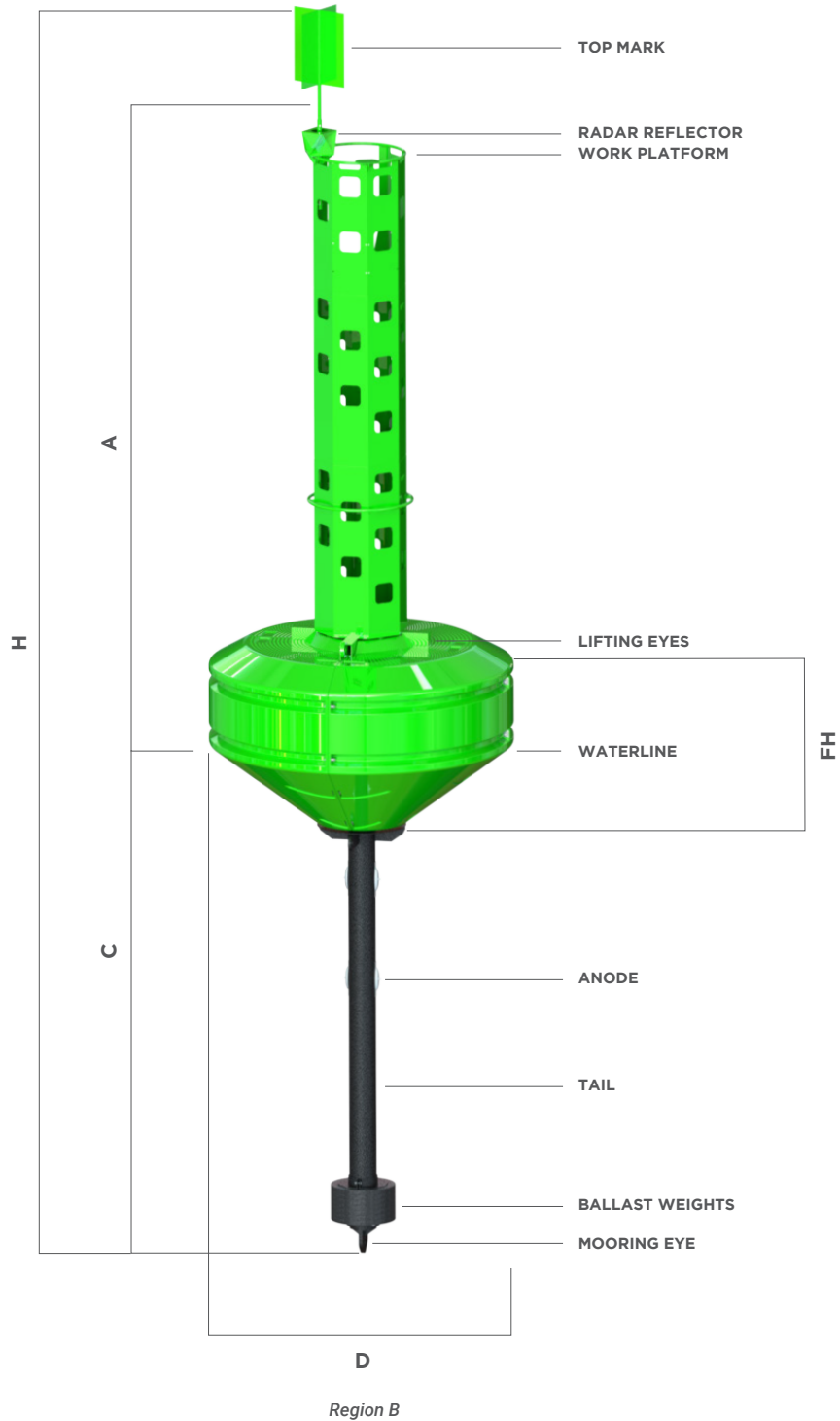

RBM30

■ Versions

RBM30



RBM30HV

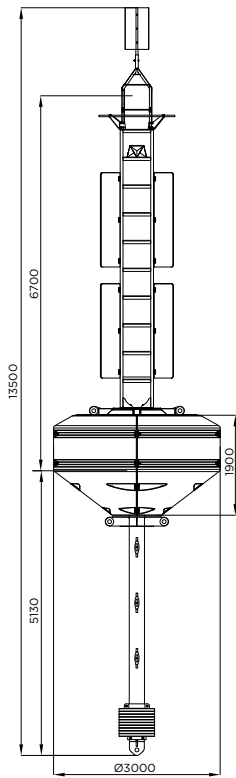

Region A

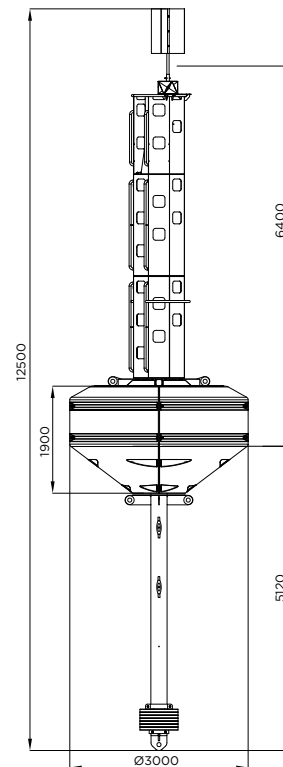

Region B

RBM30

Superstructure

Material:	Hot-dip galvanized steel.
Coating:	UV- and corrosion-resistant polyurethane paint.
Day marks:	GRP.
Top mark:	GRP, according to IALA Recommendation.
Radar Reflector:	10 m ² (X band).
Lifting eyes:	2 nos.
Hardware:	Stainless-steel.

Float

Diameter:	3.0 meters.
Material:	12 mm thickness rotomoulded virgin polyethylene.
Filling:	Closed-cell polystyrene (15 kg/m ³).

Tail

Material:	Hot-dip galvanized steel.
Ballast weights:	Treated steel, detachable.
Mooring eye:	1 no.
Protection:	Sacrifice anodes.

Options

- Superstructure made from stainless-steel or marine aluminium.
- Top mark available in stainless-steel.
- High-visibility day marks.
- Cast-iron ballast weights.
- Polystyrene filling available under request.
- Short tail available (PBM30).
- Other thicknesses available on request.



Specifications subject to change without previous notice.

